



DTAC UNITS

Remote Mount Condenser

07-36002 Series



FEATURES

- Available 12 or 24 Volt
- Built in Receiver-Drier
- Single Speed Motor
- One 10", 4 Blade
- Gray Powder Coat Finish

SPECIFICATIONS

UNIT NO.	BTU'S COOL	AIR FLOW	HEIGHT	WIDTH	DEPTH	WEIGHT	MOTOR	CURRENT DRAW
07-36002-12	33,000	740 CFM	10.5"	29.25"	12.25"	42 LBS	1-12V	12.6 AMPS @ 13.6 VDC
07-36002-24	33,000	740 CFM	10.5"	29.25"	12.25"	42 LBS	1-24V	6.4 AMPS @ 27.2 VDC

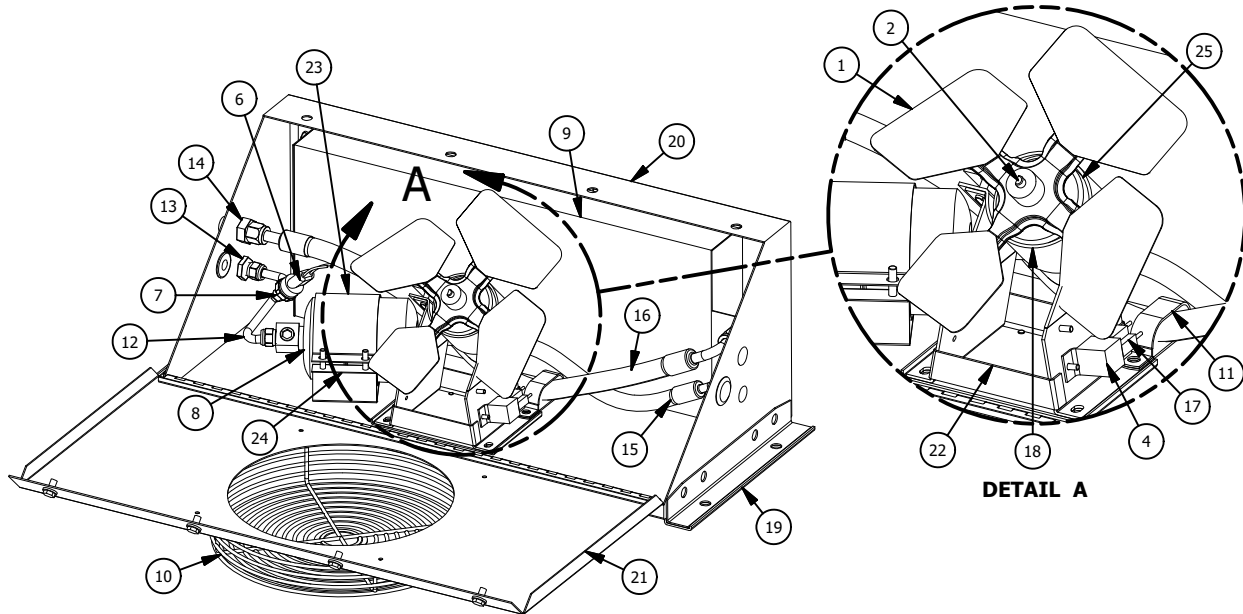

07-36002 PARTS LIST						07-36002 PARTS LIST					
ITEM	QTY 12V	QTY 24V	DTAC NO.	DESCRIPTION	NOTES	ITEM	QTY 12V	QTY 24V	DTAC NO.	DESCRIPTION	NOTES
1	1	1	02-16008	Fan Blade		14	1	1	09-50004	#8 Bulkhead w Jam Nut	
2	1	1	02-48005	12V Cond. Motor		15	1	1	10-36007	#6 Hose	
3	1	1	02-48105	24V Cond. Motor		16	1	1	10-36008	#8 Hose	
4	1	1	03-01702	12V Relay		17	1	1	12-00095	Wire Harness	
5	0	1	03-01704	24V Relay		18	1	1	12-00130	Motor Mount Brkt	
6	1	1	03-13036	Binary Boot		19	2	2	36-36003	Mounting Brkt, 36000	
7	1	1	03-34070	Binary Pressure Switch		20	1	1	36-36004	Bottom Housing	
8	1	1	06-12040	Rec. Drier		21	1	1	36-36005	Lid 36000	
9	1	1	07-35001	07-35001		22	1	1	36-36008	Motor Mount	
10	1	1	07-36008	Grille		23	1	1	36-36009	Drier Brkt Top	
11	1	1	09-04004	Double Hose Clamp		24	1	1	36-36011	Drier Brkt Base	
12	1	1	09-37595	Drier Outlet Fitting		25	1	1	40-00005	Motor Mount Brkt	
13	1	1	09-50003	#6 Bulkhead w Jam Nut							