



DTAC UNITS

Remote Mount Condenser

07-36002 Series



FEATURES

- Available 12 or 24 Volt
- Built in Receiver-Drier
- Single Speed Motor
- One 10", 4 Blade
- Gray Powder Coat Finish

SPECIFICATIONS

UNIT NO.	BTU'S COOL	AIR FLOW	HEIGHT	WIDTH	DEPTH	WEIGHT	MOTOR	CURRENT DRAW
07-36002-12	33,000	740 CFM	10.5"	29.25"	12.25"	42 LBS	1-12V	12.6 AMPS @ 13.6 VDC
07-36002-24	33,000	740 CFM	10.5"	29.25"	12.25"	42 LBS	1-24V	6.4 AMPS @ 27.2 VDC

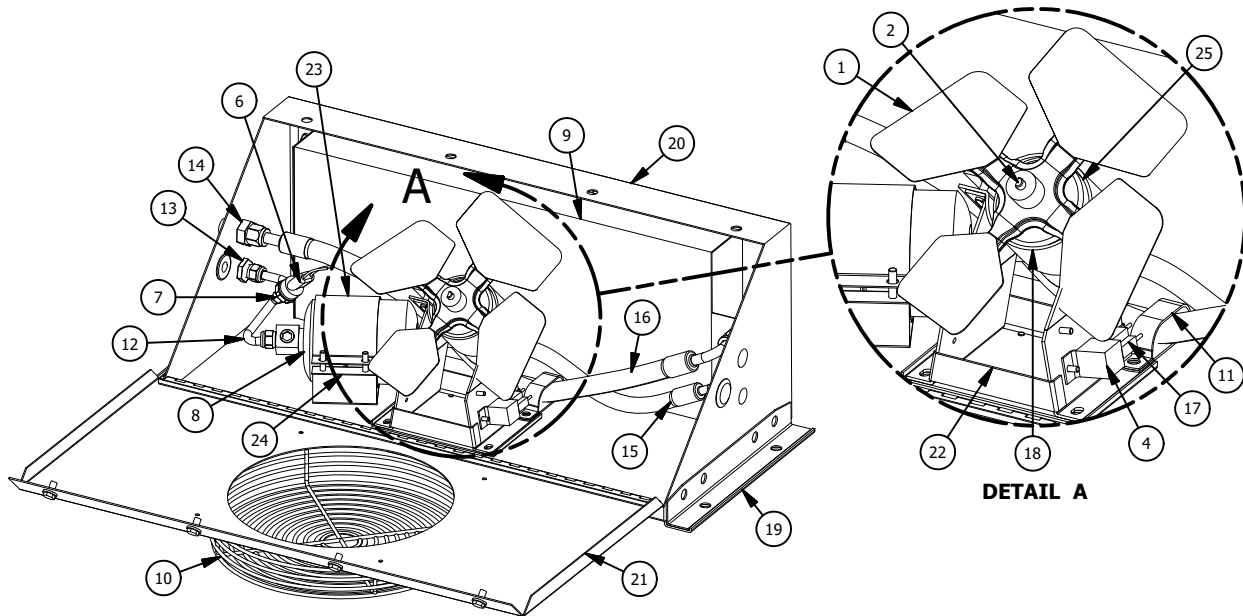

07-36002 PARTS LIST						07-36002 PARTS LIST					
ITEM	QTY 12V	QTY 24V	DTAC NO.	DESCRIPTION	NOTES	ITEM	QTY 12V	QTY 24V	DTAC NO.	DESCRIPTION	NOTES
1	1	1	02-16008	Fan Blade		14	1	1	09-50004	#8 Bulkhead w Jam Nut	
2	1	1	02-48005	12V Cond. Motor		15	1	1	10-36007	#6 Hose	
3	1	1	02-48105	24V Cond. Motor		16	1	1	10-36008	#8 Hose	
4	1	1	03-01702	12V Relay		17	1	1	12-00095	Wire Harness	
5	0	1	03-01704	24V Relay		18	1	1	12-00130	Motor Mount Brkt	
6	1	1	03-13036	Binary Boot		19	2	2	36-36003	Mounting Brkt, 36000	
7	1	1	03-34070	Binary Pressure Switch		20	1	1	36-36004	Bottom Housing	
8	1	1	06-12040	Rec. Drier		21	1	1	36-36005	Lid 36000	
9	1	1	07-35001	07-35001		22	1	1	36-36008	Motor Mount	
10	1	1	07-36008	Grille		23	1	1	36-36009	Drier Brkt Top	
11	1	1	09-04004	Double Hose Clamp		24	1	1	36-36011	Drier Brkt Base	
12	1	1	09-37595	Drier Outlet Fitting		25	1	1	40-00005	Motor Mount Brkt	
13	1	1	09-50003	#6 Bulkhead w Jam Nut							



PREVENTATIVE MAINTENANCE

DTAC strives to manufacture A/C systems of superior quality. However, as with all mechanical equipment, normal maintenance must be performed for your A/C to function at peak capacity. A well-maintained A/C system will save on down time and premature component failures.

Weekly inspections or every 2 days in severe environments should include:

1. Inspect compressor clutch drive belts (tightness, wear).
2. Inspect compressor mounting brackets (bolts, alignment).
3. Inspect mounting hardware on evaporator unit and condensers.
4. Inspect air intake filter. (Clean or replace filter).
5. Inspect evaporator and condenser coils. (Clean using air pressure. **DO NOT USE WATER OR PRESSURE WASHERS**).
6. Inspect hose and wire harness for proper routing, leaks and wear.

Helpful Hints

Make sure the evaporator air intake area is not obstructed (i.e. toolboxes, clothing, lunch box, etc.).

Manual thermostats on our systems, when rotated clockwise to the stop position will not allow the A/C compressor clutch to cycle. The compressor will run continuously and the evaporator coil will not defrost. **REMEDY:** Turn the manual thermostat knob clockwise to the stop position, then turn the thermostat knob back counter clockwise $\frac{1}{4}$ turn.

DTAC thanks you for purchasing our units. It is our endeavor to provide you with a quality A/C unit with trouble free service.