

SECTION A-A

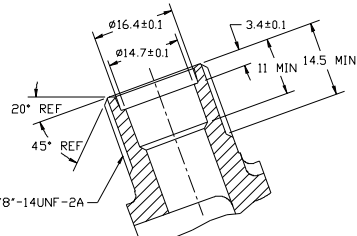

SECTION B-B

SCALE: 2:1
(SECTION SHOWN WITH SEAL CAP REMOVED)

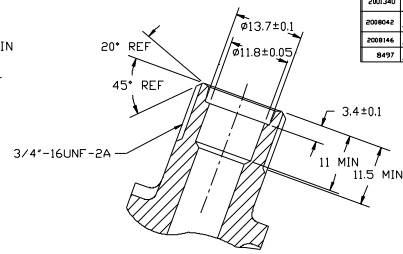

SECTION C-C

SCALE: 2:1
(SECTION SHOWN WITH SEAL CAP REMOVED)

PRCN	REV	APPV	DATE	REVISIONS	DWN	ESGN	CHK	APPV
95203	Δ	95203		ADDED PROPRIETARY NOTE AND UPDATED TO CURRENT STANDARDS	JK	JKL	JKL	JKL
95986	Δ	04/19/99		CHANGED TO 3PHILE FIELD COIL	JK	JKL	JKL	JKL
200340	Δ	11/06/01		UPDATED TO CURRENT TITLE BLOCK COIL COP-150 MASS DRG COP-210	JKR	JKL	JKL	JKL
200842	Δ	7/15/08		UPDATED TO REFLECT LATEST REVISION OF COIL HEAR 7932-0450	JK	AA	SN	RM
200844	Δ	12/04/08		ADDED JUMPER ASSY	JK	JK	JK	JKL
8497	Δ	3/18/09		THE NOTE WAS - CONNECTORS ENGAGED	JK	JK	JK	JKL

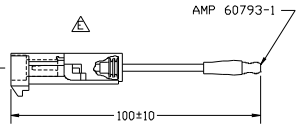

ASSEMBLED COMPRESSORS TO HAVE CONNECTORS NOT ENGAGED (4860-0400)

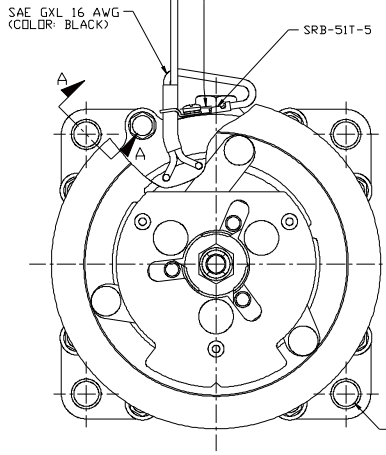
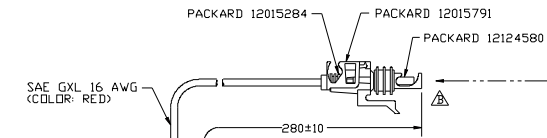

CLOCKWISE ROTATION

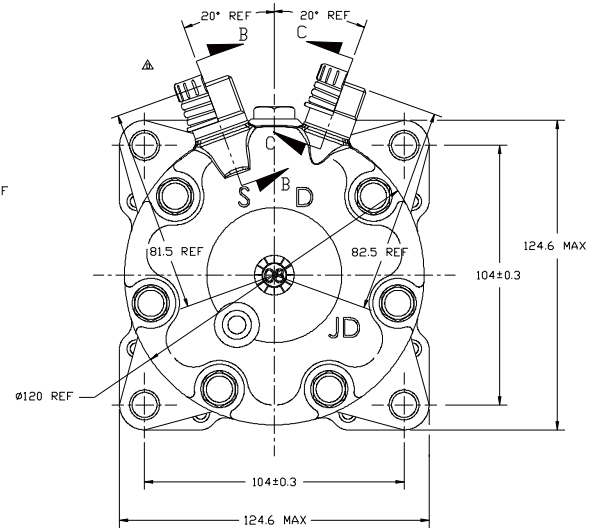
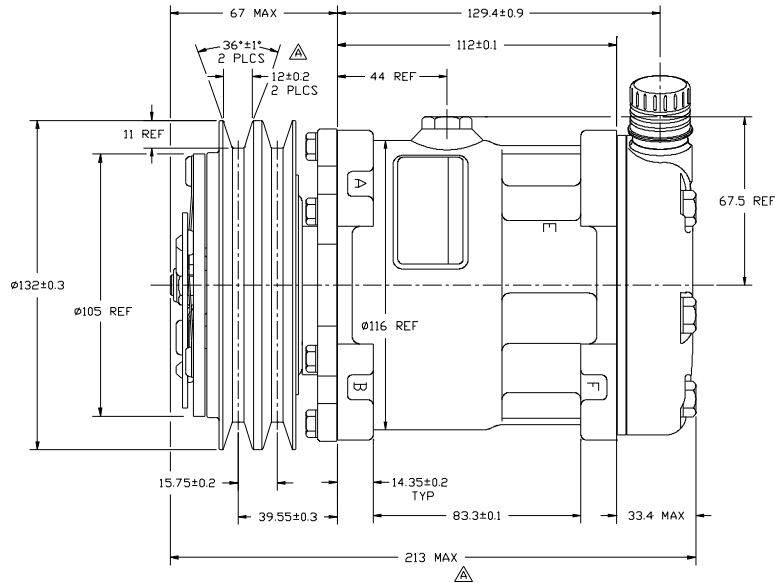

COMPRESSOR SPECIFICATIONS

DISPLACEMENT PER REVOLUTION	154.9 cc / rev. (9.5cuin. / rev.)
MAXIMUM ALLOWABLE R.P.M.	8000 R.P.M.
MAXIMUM ALLOWABLE CONTINUOUS R.P.M.	6000 R.P.M.
REFRIGERANT	R134a
OIL (SP-15)	240 cc (8.1 floz.)
WEIGHT	7.6 kg (16.8 lb.)

CLUTCH SPECIFICATIONS

RATED VOLTAGE	DC 12V
BREAKAWAY TORQUE	3.5 kgf·m-min. @ 12V
MINIMUM ENGAGEMENT VOLTAGE	7.5V @ air gap 0.6mm REF
POWER CONSUMPTION	49 watts max.
BELT TYPE	A TYPE
MAXIMUM ALLOWABLE BELT TENSION	60 kgf per belt
PULLEY DIAMETER	Ø132 mm (5.2 in.)
CLUTCH TYPE	HEAVY DUTY

REV	LEVEL	RELEASED FOR	DATE	DESCRIPTION
A	Δ	DESIGN DEVELOPMENT	02/01/00	INITIAL DEVELOPMENT
A	Δ	DESIGN VALIDATION	02/01/00	DESIGN VALIDATION
A	Δ	PRODUCTION VAL.	02/01/00	PRODUCTION VAL.
A	Δ	PRODUCTION	02/01/00	PRODUCTION
A	Δ	PRODUCTION	02/01/00	PRODUCTION

SANDEN	
SANDEN INTERNATIONAL (U.S.A.), INC.	
DRAWN	SCALE REF: 1:1
PLOTTED	SCALE REF: 1:1 METRIC
This drawing and the information contained herein are CONFIDENTIAL and PROPRIETARY to Sanden International (U.S.A.), Inc. and are released in CONFIDENCE and shall not be used, copied, or disclosed to others without the written permission of Sanden International (U.S.A.), Inc.	
INTERPRETATION OF THIS DRAWING PER ASME Y14.5M-1994	
THIRD ANGLE PROJECTION	SIZE D
MATERIAL:	
NAME: COMPRESSOR OUTLINE	
ENG. NO:	4664-6000
REV	F

DO NOT SCALE