



EVAPORATORS

331 Series

Heat/Cool with Remote Switch, Ceiling Mount



FEATURES

- Available 12 or 24 Volt
- Heavy Duty Metal Construction
- Fully Insulated Case Reduces Condensation
- Removable Lid for Easy Access
- Filtered Intake Air
- 6 – 3.5" Directional Round Louvers for Maximum Air Flow
- Steel Case with Black Powder Coat Finish

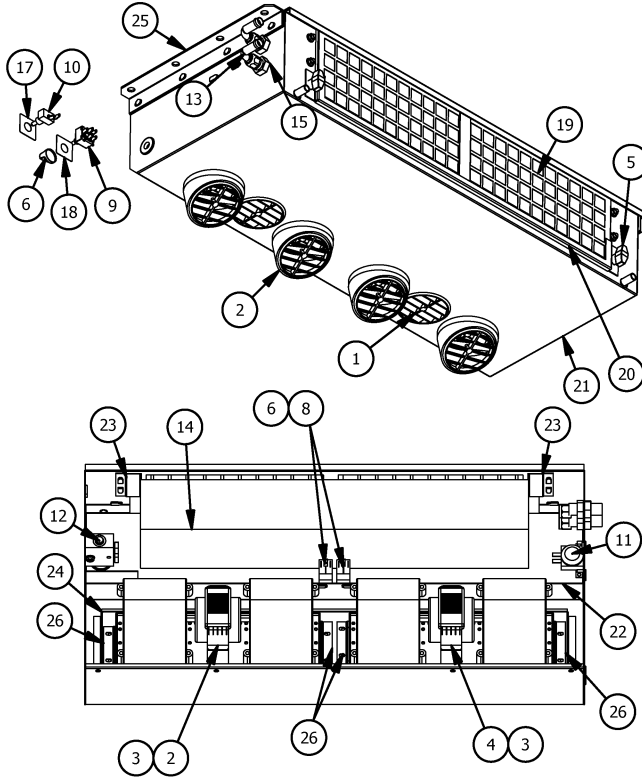

Internal Components

331 PARTS LIST					
ITEM	QTY 12V	QTY 24V	DTAC NO.	DESCRIPTION	NOTE
1	2	2	02-16061	3-1/2" Louver	
2	4	4	02-16073	3.5" Angled Louver	
3	2	0	02-17512	12V Blower Assembly	
4	0	2	02-17524	24V Blower Assembly	
5	2	2	03-00164	Knob	
6	1	1	03-00165	Knob	
7	2	0	03-01702	12V Relay	
8	0	2	03-01704	24V Relay	
9	1	1	03-13006	Rotary 3-Speed Switch	
10	1	1	03-13020	Toggle Switch	
11	1	1	03-14013	Preset Thermostat	
12	1	1	04-15004	Block Expansion Valve	
13	2	2	05-00301	90 Degree Heater Fitting	
14	1	1	07-00330	H/C Coil	
15	2	2	09-50004	#8 Bulkhead With Nuts	
16	1	1	12-00331	Wire Harness	1
17	1	1	12-50420	Face Plate - Heat/Cool	
18	1	1	12-50421	Face Plate - Air Increase	
19	2	2	14-10000	141 Intake Filter	
20	1	1	33-00003	Filter Brkt	
21	1	1	33-00007	Housing	
22	1	1	33-00008	Drain Pan	
23	2	2	33-00010	Coil Brkt	
24	1	1	33-00012	Blower Plenum	
25	1	1	33-10000	Lid 331	
26	4	4	70-51597	Blower Motor Retainer	
27			NOTE 1	Not Shown	

EVAPORATORS

BTU'S HEAT	BTU'S COOL	AIR FLOW	HEIGHT	WIDTH	DEPTH	REMOTE HARNESS	MOTOR	CURRENT DRAW	DTAC NO.
35,000	40,000	465 CFM	6.68"	36.75"	16"	Y	2-12V	25 AMPS @ 13.6 VDC	331-12A
"	"	"	"	"	"	"	2-24V	15 AMPS @ 27 VDC	331-24A